

# Strawberry Shortcake

569.124

© 2013 Art Form Architecture, Inc. All Rights Reserved . <http://www.artformhomeplans.com>



What do you call a short cape? Well, if you're Wendy, you call it a Shortcake! In this case Strawberry. Our Strawberries all have a combination of shed dormers on the front. In the Shortcake version it's a peekaboo shed putting windows high in the baths (above a one piece tub/shower) and then we flipped the roof up over the porch, which just opens it right up and let's lots of sun into the living room.

We kept the shortcakes narrow for narrow lots. With a full first floor bedroom suite, that means a fairly deep plan (deep meaning front to back). Even with an 8:12 roof we get lots of space upstairs, enough for a full compliment of 3 bedrooms, 2 baths, walk-in closets and an optional laundry.

See more plans in the [Bakery Series](#) Collection.

|                   | Living Area    | Bedrooms | Bathrooms  | Ceiling Height Shown | Ceiling Height Possible* |
|-------------------|----------------|----------|------------|----------------------|--------------------------|
| First Floor       | 1064 SF        | 1        | 1.5        | 8'-0"                | 9'-0"                    |
| Second Floor      | 972 SF         | 3        | 2.0        | 9'-0"                | 9'-0"                    |
| Total Above Grade | <b>2036 SF</b> | <b>4</b> | <b>3.5</b> |                      |                          |
| Basement          | 0 SF           | 0        | 0.0        |                      |                          |

\* -- Increasing ceiling height requires a Major Change.

<http://www.artformhomeplans.com/Contact.a5w>

<http://www.artformhomeplans.com/TermsConditions.a5w>

# Strawberry Shortcake

569.124

© 2013 Art Form Architecture, Inc. All Rights Reserved . <http://www.artformhomeplans.com>



## First Floor

**Living Area:** 1064 SF

**Bedrooms:** 1

**Bathrooms:** 1.5

**Ceiling Height Shown:** 8'-0"

**Ceiling Height Possible\*:** 9'-0"

\* -- Increasing ceiling height requires a Major Change.

This floor expands easily left to right, but it looks best if both garage and living are expanded equally.





# Strawberry Shortcake

569.124

© 2013 Art Form Architecture, Inc. All Rights Reserved . <http://www.artformhomeplans.com>

## Basement Floor

**Living Area:** 0 SF

**Bedrooms:** 0

**Bathrooms:** 0.0

**Ceiling Height Shown:** 7'-8"

**Ceiling Height Possible\*:** 9'-0"

\* -- Increasing ceiling height requires a Major Change.

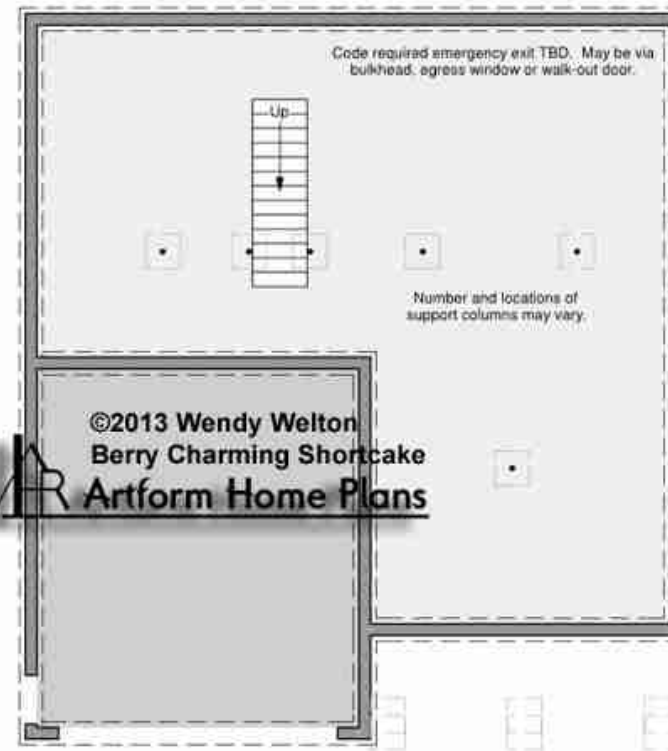

# Strawberry Shortcake

569.124

© 2013 Art Form Architecture, Inc. All Rights Reserved . <http://www.artformhomeplans.com>

## Heights



AFHP Default Grade \*1 is 1'-9" below first floor subfloor for consistency in how we list height on the web site. The distance to grade is often more. Talk to your builder.

\*3 Height for zoning may be measured from the grade at the front, the lowest grade or an average. Talk to your builder and/or governing officials.

# Strawberry Shortcake

569.124

© 2013 Art Form Architecture, Inc. All Rights Reserved . <http://www.artformhomeplans.com>

## Alternate Looks

This design is part of the Berry Charming Shortcakes collection. This floor plan can be adapted to any of the other Looks in the collection, shown below. There may be differences in floor plans, especially at the second floor front.

**Vanilla** © 2013 Wendy Welton



**Boysenberry** © 2013 Wendy Welton



**Strawberry** © 2013 Wendy Welton



**Blueberry** © 2013 Wendy Welton

